

S-Jet: Fusion of Two Methods

Ventilated Rotary Nozzle with Integrated Hose Grommet

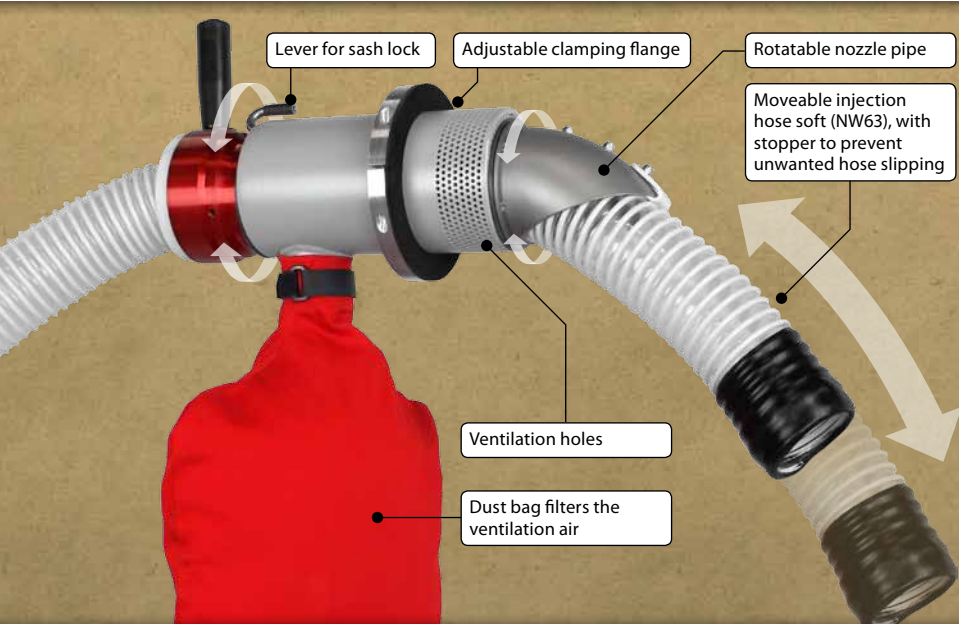

www.x-floc.com



- Combines the advantages of hose and nozzle injection
- Ventilated, low-dust injection
- Ideal for walls, pitched roofs and ceilings
- Can be used as a ventilated nozzle



Also available with harder injection hose.

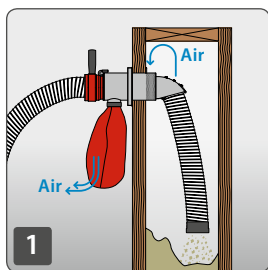

1 Filling a stud cavity: Position the hose so that the end is almost at the bottom of the cavity

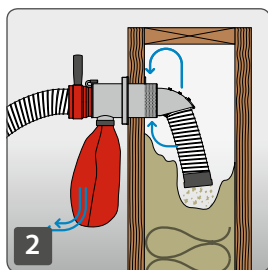

2 Pull the hose gradually out of the cavity

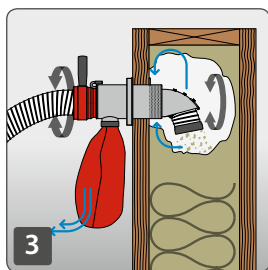

3 When the end of the hose is level with the pipe, operate like a rotary nozzle

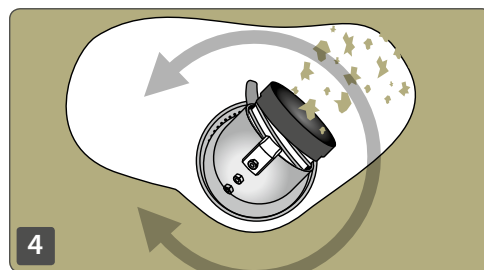

4 The corners of the stud cavity can also be filled by rotating the nozzle head

The S-Jet is the next logical step in the development of rotary nozzle technology. Now, using only one piece of equipment, deep cavities can be filled with a uniform density of insulation material right up to the injection hole. The hose is initially inserted almost to the bottom of the cavity, and then pulled out gradually during the filling procedure. The stopper prevents the hose from accidentally slipping out of the nozzle. Our proven rotary nozzle technology can then be employed to inject material into the area above the injection hole.

Further Advantages and Equipment:

- ▶ Completely ventilated hose and rotary nozzle injection
- ▶ Hose grommet minimises material loss
- ▶ Can be used with planking thicknesses of up to 80 mm
- ▶ For insulation layers from 160 mm thickness
- ▶ Recommended injection hole diameter: 106 mm
- ▶ Includes NW63 (2 1/2") conveyor hose or injection hose

The ventilation holes and dust bag guarantee excellent ventilation and minimal dust development.



The sash lock and adjustable flange seal the injection hole, making the injection process easy and convenient.

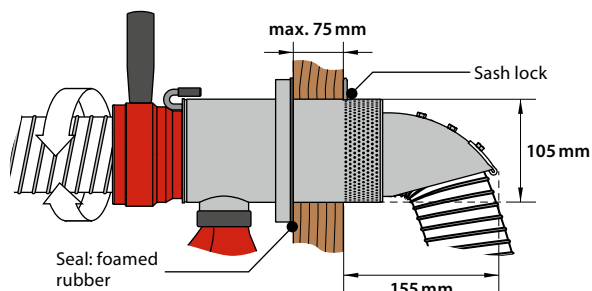

Data

Typ	Planking mat.	Insulation thickness	Art.-No.
NW63	10...75 mm	from 160 mm	4910

Equipment

Image	Description	Art.-No.
	Hole saw Ø 106,5 mm with ejector system; HSS/SDS available	4966
	Pro hole saw Ø 106,5 mm	6182
	Hole saw HF Ø 106,5 mm wood fibre pane	5917
	Sealing corks/closing plugs (wood fibre) 106 mm	1948/4673