

Insulating Needles with Piercing Head

Accurate Filling and Densifying

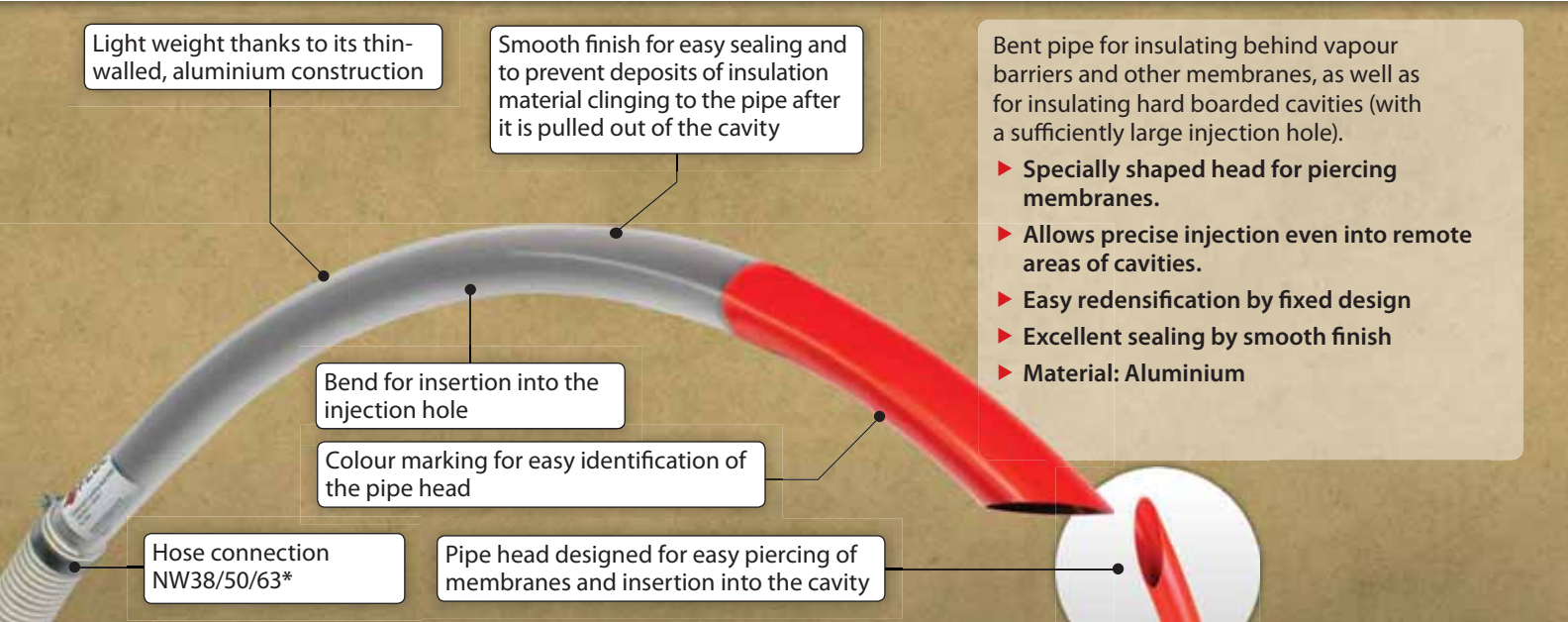

* For the insulating needles we suggest our connection sets: See next page...

Available Dimensions

Insulating needle $\underbrace{\text{NW50-144}}_{D_s \quad L} \rightarrow \text{NW50} = 2''$

Insulating needle	S_D	\varnothing	Drill hole \varnothing *	L [cm]	Id.no.
NW38-90	> 70 mm	1 1/2"	106,5	90	5304
NW50-80	> 90 mm	2"	106,5	80	6180
NW50-130	> 200 mm	2"	120	130	5303
NW63-124	> 200 mm	2 1/2"	120	124	5836
NW50-184	> 240 mm	2"	120	184	5153
NW63-184	> 240 mm	2 1/2"	120	184	6390
NW75-120	> 240 mm	3"	150	120	6710
NW75-180	> 240 mm	3"	150	180	6711
NW38-straight	All insulation thicknesses	1 1/2"	-	up to 6 m	6028
NW50-straight		2"			5730
NW63-straight		2 1/2"			5839
NW75-straight		3"			5840

* Related to panelling depths from 12 up to 20 mm.
 S_D : Minimal insulation thickness
 \varnothing : Diameter hose connection
 L: Total length

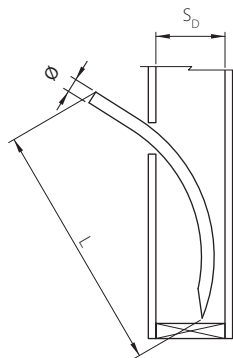
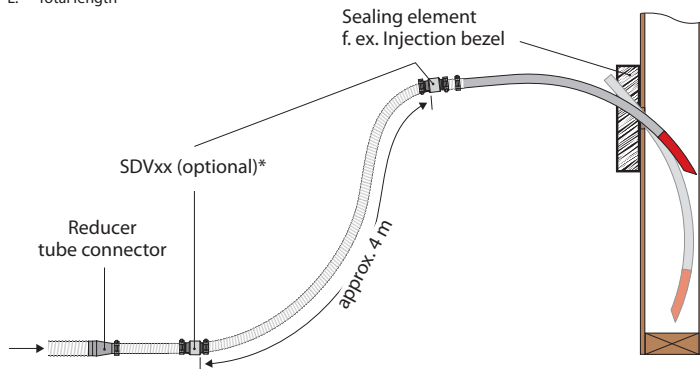

Insulating needle in application with sealing sponge

Hands-free for the injection tool with the practical injection bezel with clamps for fixation

Beispiel: Stud Wall

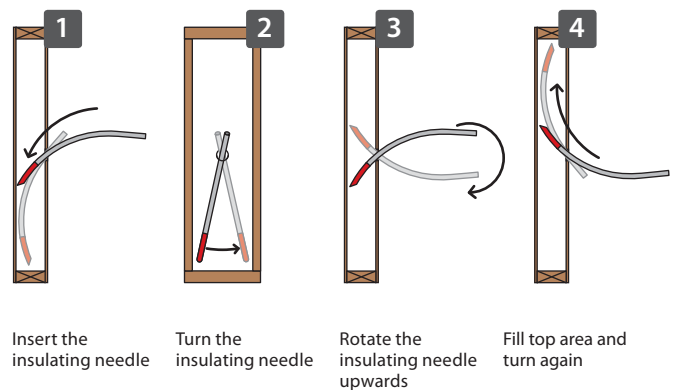

Example: Roof Pitch and Ceiling

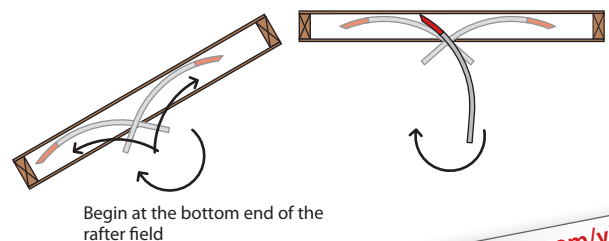

Suggestions for Connection and Preparation:

- ▶ Good mobility by long previous working hose
- ▶ Avoidance of blockages
- ▶ Highest possible processing speed

* We recommend the rotary hose connector, because the rotary hose connector enable easily rotated and the working with the insulation needle is facilitated. They are available as an option.

Suitability matrix

In the diagram shown below you can read, how big must the drill hole be for the needle. This depends on the insulation thickness, the panelling depth, the injection hole and on the type of insulating needle.

Example:

Insulation thickness $t = 20\text{cm}$

Panelling depth $s = 35\text{mm}$

Insulating needle = NW50

Therefore, the injection hole diameter has to be approximately 11 cm (see [reading example](#)).

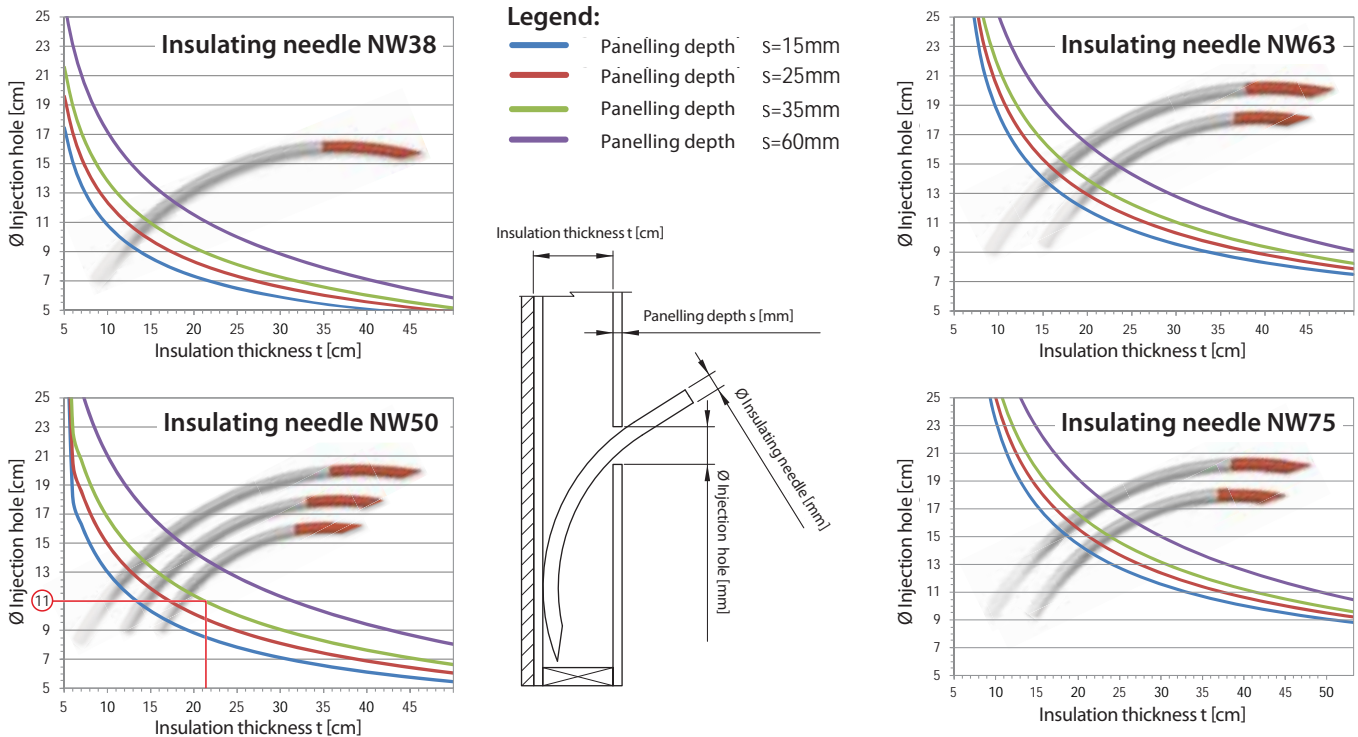

Recommended Injection Holes

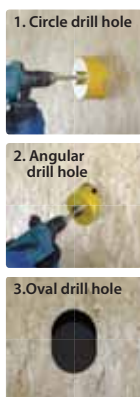
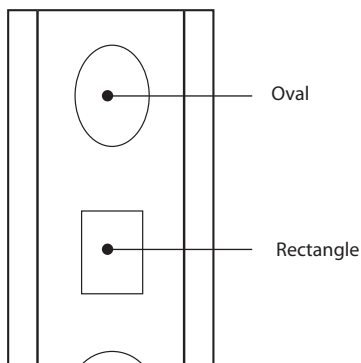











Available Connection Sets

All connection sets will be delivered with a flexible conveyor hose.

Reducer connector	Hose	Hose clamps	Id.no.
1 x NW63 > 38 (2 1/2" > 1 1/2")	1 x NW38 (2"); length 4m	2 x NW38 (1 1/2")	6104
1 x NW63 > 50 (2 1/2" > 2")	1 x NW50 (2"); length 4m	2 x NW50 (2")	6206
1 x NW75 > 50 (3" > 2")	1 x NW50 (2"); length 4m	2 x NW50 (2")	6103
1 x NW75 > 63 (3" > 2 1/2")	1 x NW63 (2 1/2"); length 4m	2 x NW63 (2 1/2")	6124

Accessories

Image	Description	Id.no.
	Pro hole saw $\varnothing 106,5\text{mm}$	6182
	Hole saw $\varnothing 106,5/120\text{mm}$	4966/ 5282
	Hole saw HF $\varnothing 106,5\text{mm}$ wood fibre panels	5917
	Reducer tube connector NW75 > 63 NW75 > 50 NW63 > 50 NW63 > 38 NW50 > 38	1264 1262 1261 1263 1970
	Rotary hose connector SDV50	6522
	Rotary hose connector SDV75	4451
	Sealing sponge NW50/63 for use in the front of the injection hole	3947
	Sealing cork VK106/120	1948/ 4671
	Sealing plug VS109/120	8950/ 8951
	Universal injection bezel diameter = 30...60 mm diameter = 45...70 mm diameter = 65...100 mm	8787 8906 8907